

1180

Name and Post Office Address of Grantor: Shannon Forest Presbyterian Church  
Route 2 Garlington Road  
Greenville, South Carolina

Toll Line or Exchange Line tributary to: Greenville

The Property is bounded where the line enters and leaves this property by the property of:  
Snipes Road on the North east  
Mr. McAlhaney on the South west

Authority: P-43403 Classification: 94-C

City: Greenville, South Carolina

Approved: M.D. Cooper  
 Title: District Engineer

3270

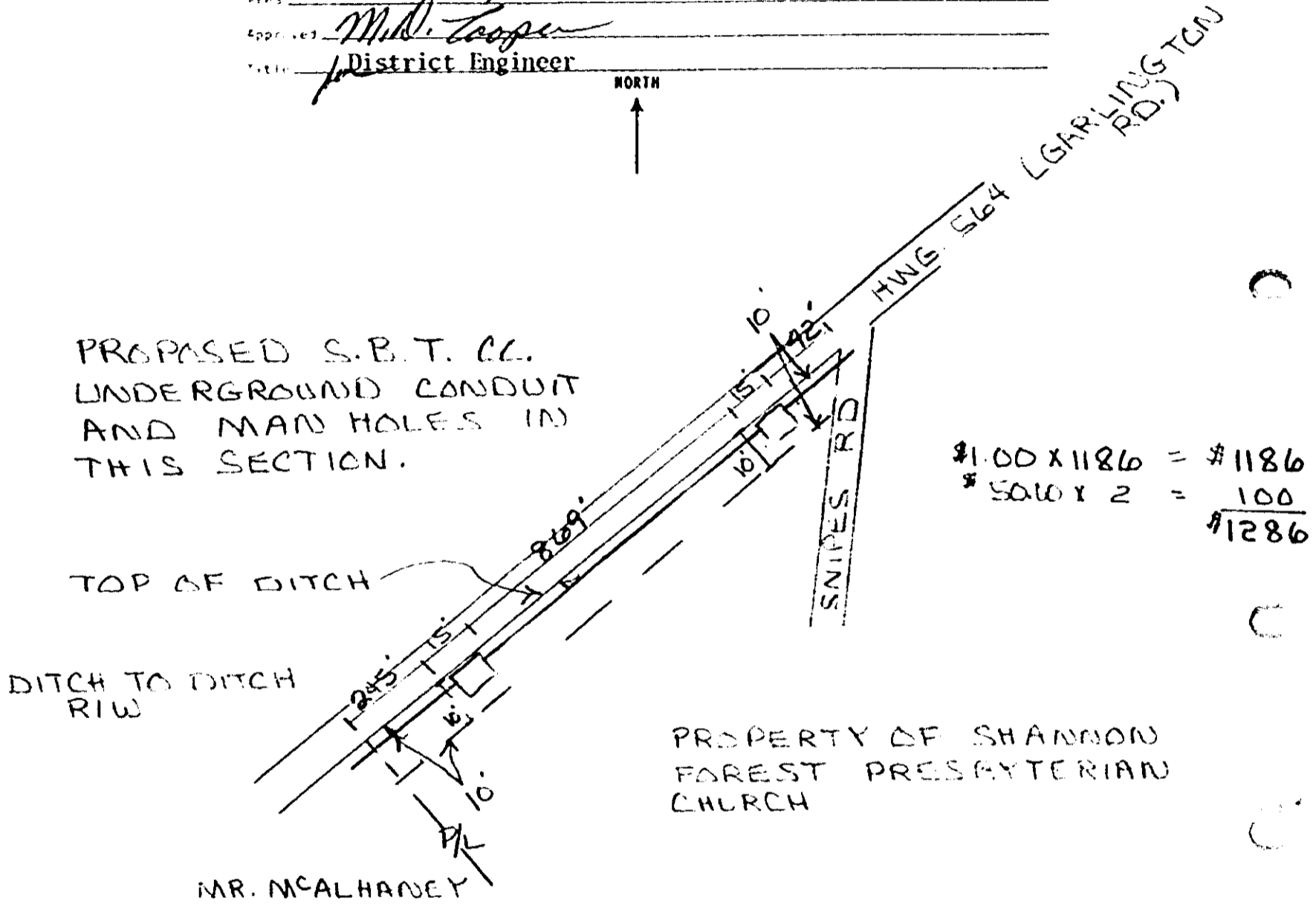

RECORDED JUN 2 1978 at 1:47 P.M. 36205

Filed for record in the office of  
 the R. M. C. for Greenville  
 county, S. C. at 1:47 o'clock  
 P. M. June 2, 1978  
 and recorded in Deed Book  
 1080 at page 428  
 R. M. C. for G. Co. S. C.

36205 XA

JUN 2 1978

4328 RV-2